

TO FLAGSTAFF

R. 7 E.

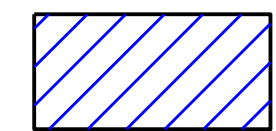
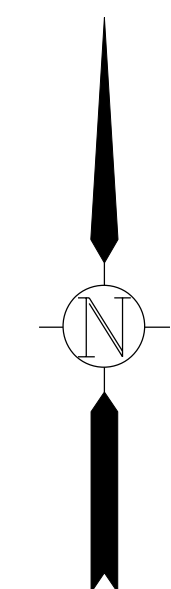
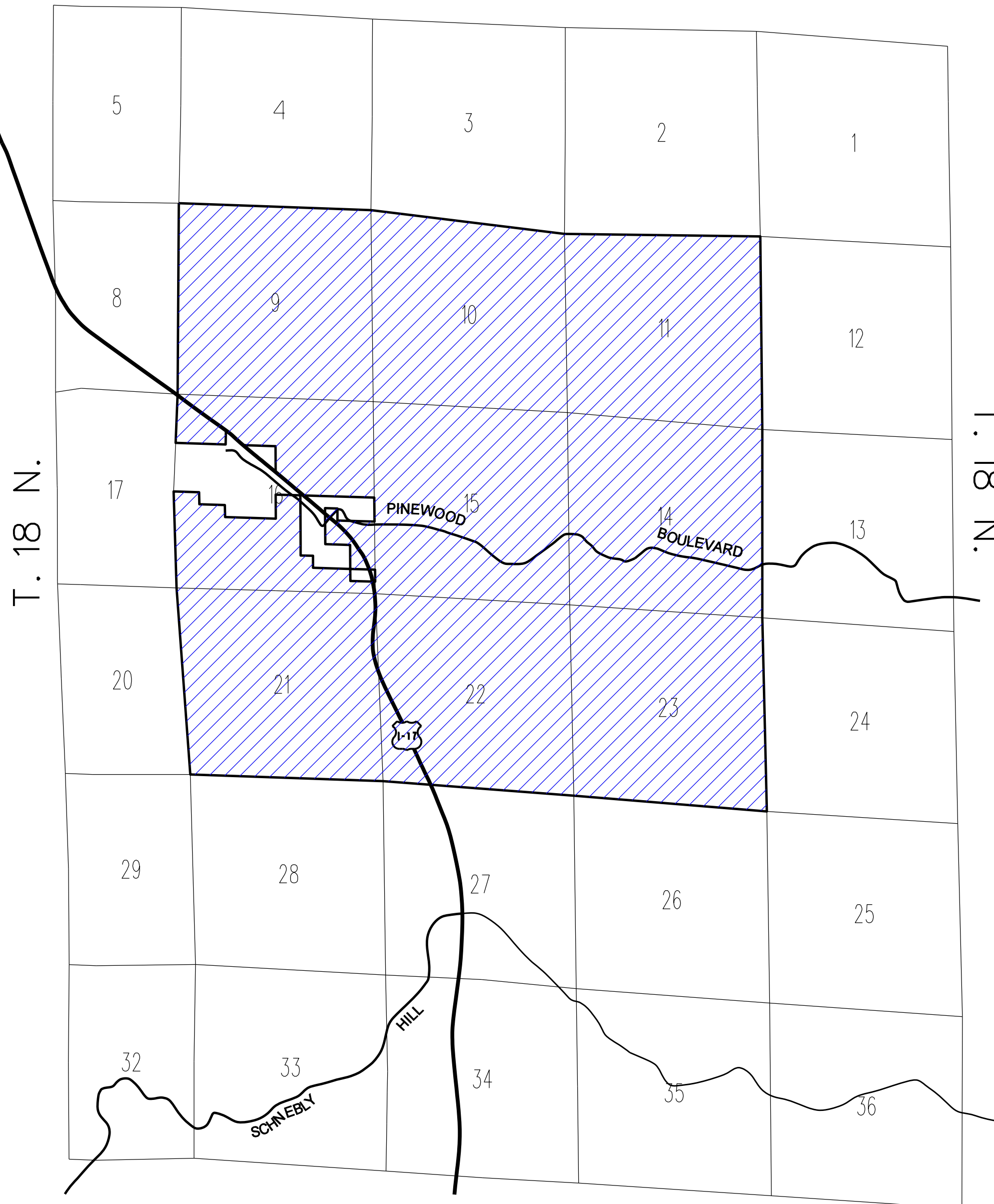

Area Covered By Present C.C.&N.

6				
5		REDRAWN	JW	11/01
4	2/70	DECISION No. 40508 (TRSFR)		
3	7/69	DECISION No. 40131 (TRSFR)	RB	8/69
2	8/63	DECISION No. 34782	RB	11/68
1	4/62	DECISION No. 33839 (TRSFR)	RB	11/68
No.	Decision Date	Revision	By	Date

ARIZONA WATER COMPANY

AREA COVERED BY PRESENT C.C.&N.
AT
PINEWOOD

DATE: 11/01 SCALE: 1" = 1/2 Mile